

SUITE 800 CONFERENCE CENTER

AT 430 NORTH MICHIGAN AVENUE



If you have any questions about room rental or to check availability, please contact:

Kirk Antkiewicz



2024 MEMBER/NON-MEMBER RATES

Audio visual equipment included

Theater Style Seating



Classroom Style Seating

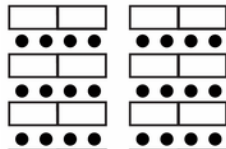

Boardroom Style Seating

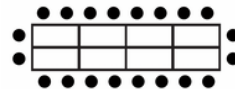

U-Shape Seating

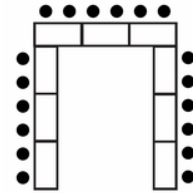

ROOM 1

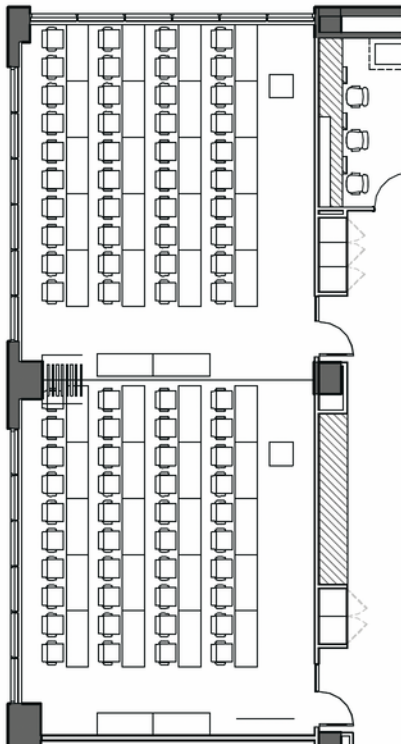

ROOM 2

ROOM 1

- ✓ Classroom Accommodates: 40
- ✓ Theater Accommodates: 50
- ✓ Boardroom Accommodates: 20
- ✓ U-Shape Accommodates: 18

Rental Rates: Member: \$375 half-day/\$675 full-day
Non-Member: \$425 half-day/\$725 full-day

ROOM 2

- ✓ Classroom Accommodates: 40
- ✓ Theater Accommodates: 50
- ✓ Boardroom Accommodates: 20
- ✓ U-Shape Accommodates: 18

Rental Rates: Member: \$375 half-day/\$675 full-day
Non-Member: \$425 half-day/\$725 full-day

ROOM 1 & 2

- ✓ Classroom Accommodates: 76
- ✓ U-Shape Accommodates: 36
- ✓ Boardroom Accommodates: 38

Rental Rates: Member: \$600 half-day/\$1,000 full-day
Non-Member: \$700 half-day/\$1,100 full-day